

NOTES

- 1) Access and egress for emergency services & residents will be maintained at all times so far as is reasonably practicable & safe
- 2) Each road closure point will be manned throughout period of works.

FullFibre.

BILL OF QUANTITIES

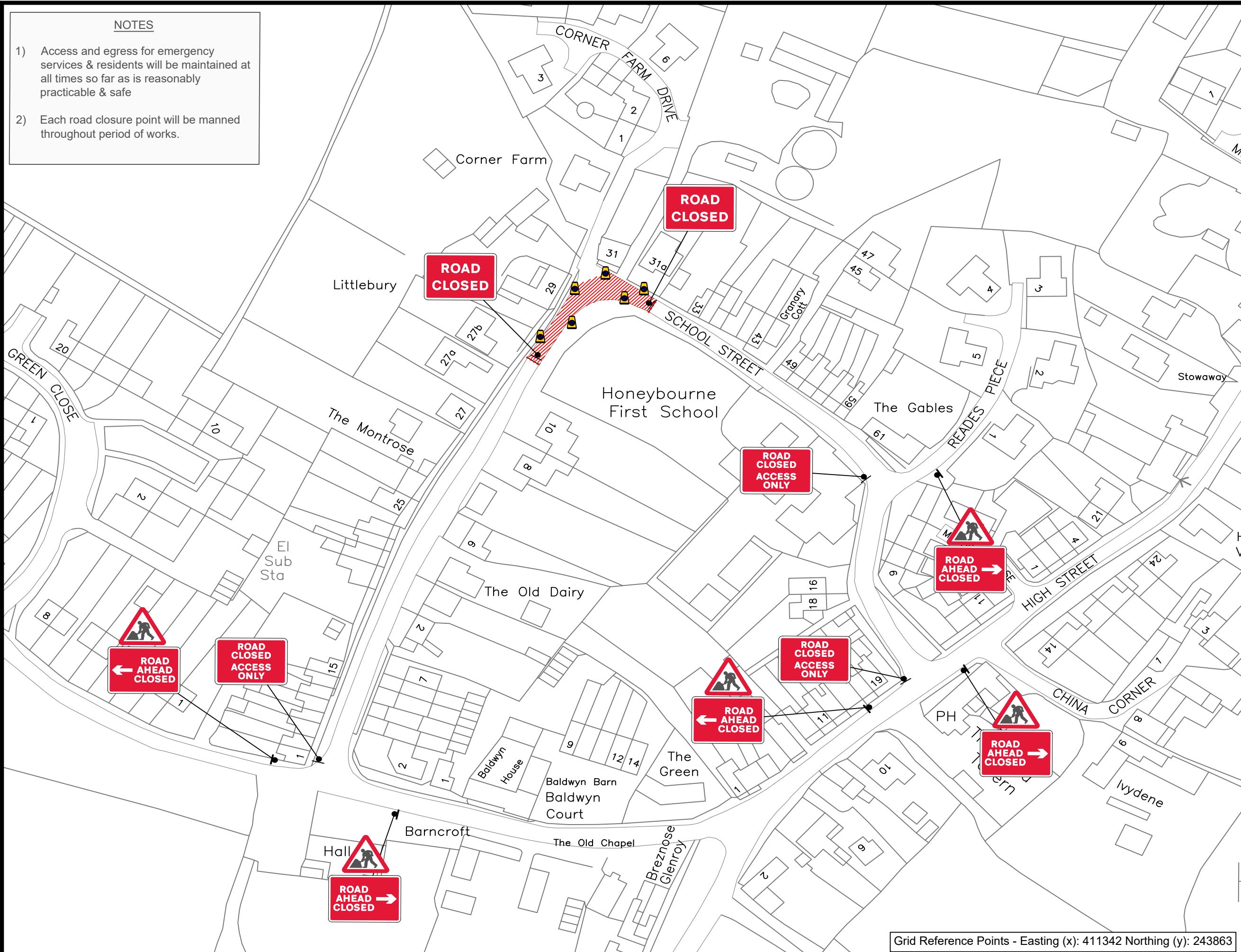

| | |
|--|--|
| Qty: 3 Ref: 13-9-RCAO Road Closed Access Only | |
| Qty: 3 Ref: 13-9 Schedule 13-9: Temporary Information | |
| Qty: 2 Ref: 13-9 Schedule 13-9: Temporary Information | |
| Qty: 5 Ref: 7001 Road works ahead | |
| Qty: 2 Ref: 7010-FP-13-9 Nature of temporary hazard ahead - Road Closed | |

This road will be CLOSED DD Month YYYY HH:MM - HH:MM for X days

NOTE
Advance warning signs to be installed prior to installation of closure.

AL Air lock system to be installed at closure points.

Grid Reference Points - Easting (x): 411342 Northing (y): 243863



| | | | | | |
|---|-----|-------|----------|---------------------|--------------------------|
| Date: | Rev | DRAWN | APPROVED | Drawing Number: | TSM-346-REV1 |
| 06.11.23 | 1 | JA | TSM | Client Reference: | job number 1247 |
| Title: | | | | Traffic Management: | Road Closure & Diversion |
| School Street, Honeybourne, Wychavon, Worcestershire, England, WR11 7PL | | | | Road Speed: | 30mph |

Key

- Diversion route
- Closed Area
- Sign

All drawings are drawn to north.

All layouts are drawn with Traffic Signs Regulation & General Layout Directions 2016 & Chapter 8 Guidelines. Using Safety At Street Works And Road Works A Code Of Practice as a guideline.
Drawing to be read with relevant method statement & risk assessment.
All sign locations are indicative and exact locations will be determined on site.
Drawn by Ackroyd Design.