

Qty: 2 Ref: 13.9 Schedule 13-9 : Temporary Information	
Qty: 1 Ref: 2702 Start of temporary diversion route	
Qty: 2 Ref: 2702 End of temporary diversion route	
Qty: 2 Ref: 2702 Start of temporary diversion route	
Qty: 1 Ref: 2703 Direction of temporary diversion route from junction ahead	
Qty: 1 Ref: 2703 Direction of temporary diversion route from junction ahead	
Qty: 3 Ref: 7001 Road works ahead	
Qty: 4 Ref: 7010-FP-13-9 Nature of temporary hazard ahead – Road Ahead Closed	
Qty: 2 Ref: 7010-FP-13-9 Nature of temporary hazard ahead – Road Closed	

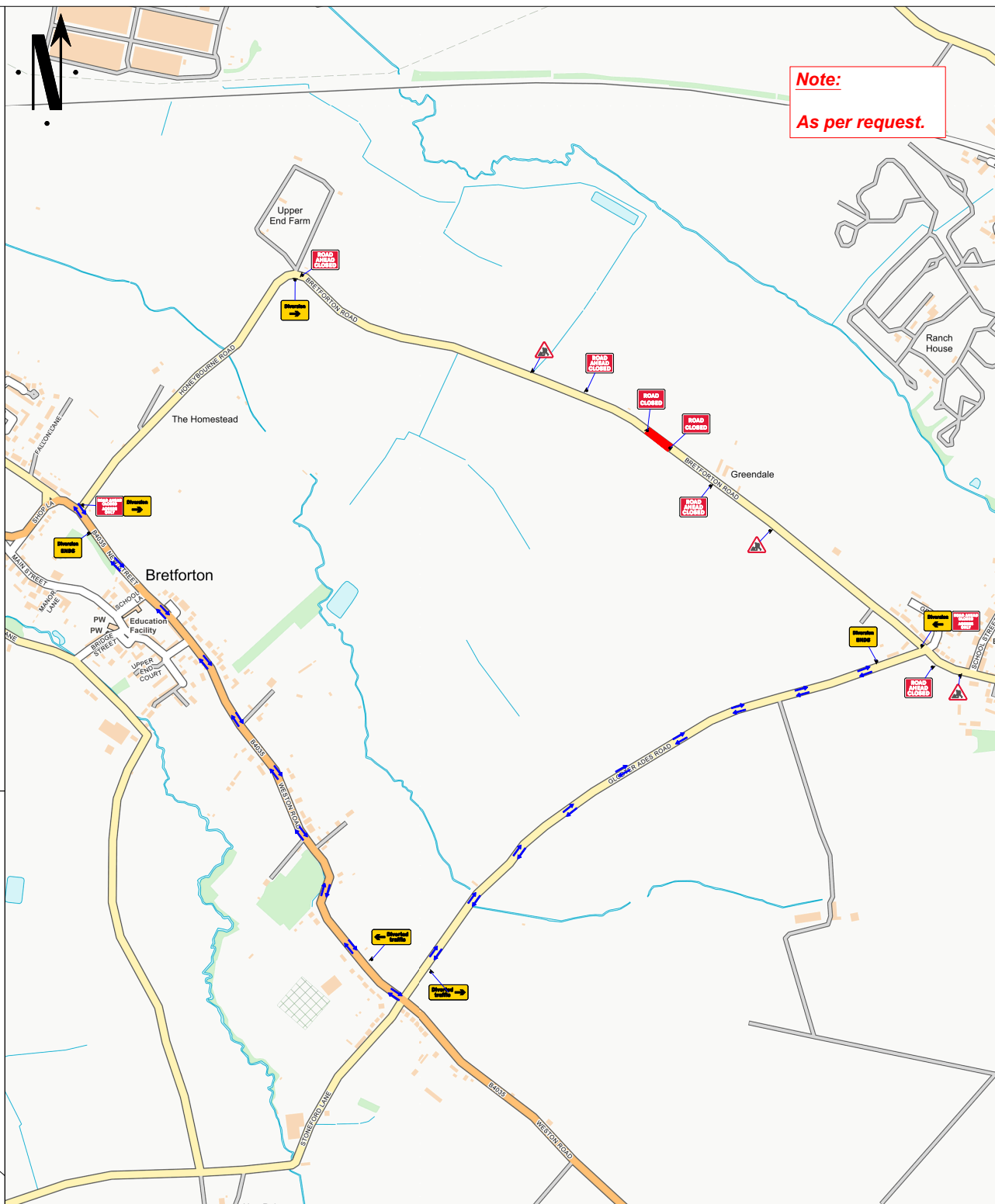
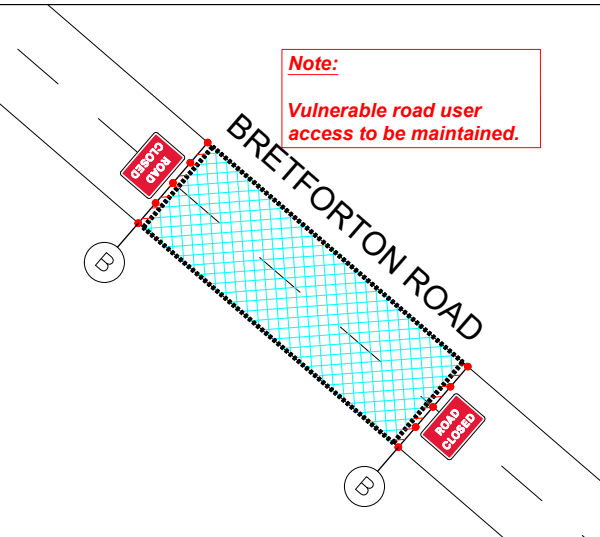

Go Traffic Management

This drawing has been produced for a specific client & project identified below and is not intended for use by any other person or for any other purpose. © Go Traffic Management

Risks

- Design completed from information provided + google maps desktop risk assessment
- Cone lamps must be used on all road with A speed limit of 40mph or more.

Notes

- All signs as per Chapter 8. Distances between cones to be 9m maximum unless otherwise noted.
- Distances between signs NOT to scale for purpose of clarity.
- All sign placement subject to available working space.
- The purpose of the Traffic Management Plan is for it to be used only as a guide and all traffic management equipment should be put out according to the 'Safety at Street Works and Road Works - Code of Practice', i.e. Red Book & the 'Traffic Signs Manual Chapter 8', i.e. Yellow Book.
- Signs must be placed in accordance with TSM and the scheme RAMS pack.
- Site conditions may have changed since the design of the drawing any changes which subsequently affect the design need to be reported by the Traffic Management Operative & any changes implemented must comply with Chapter 8.

Key

	Sign position and aspect of view		Working Space
	Cones		Diversion Route 1

CLOSED - BRETFORTON ROAD
DIVERSION VIA - HONEYBOURNE ROAD, WESTON ROAD, GLOSTER AISES ROAD & VICE VERSA

MINIMUM 0.5M
SIDEWAYS & 0.5M
LONGWAYS SAFETY
ZONE MUST BE
ADHERED TO

WORK AREA GREATER/LESS
THAN 0.5 MILES

Traffic Management must comply with The Safety at Street Works and Road Works Code of Practice

ROAD SPEED

CROSS SECTION

DO NOT SCALE FROM THIS DRAWING

ROAD CLOSURE

A	04/11/25	AS DRAWN
REV.	DATE	DESCRIPTION

GTM
Go Traffic Management

Head Office: Go Traffic Management,
Chaddock Lane, Worsley, Manchester, M28 1XW
Tel: 0161 351 5370
www.gtm.co.uk

TRAFFIC MANAGEMENT PLAN

Client: **SEVERN TRENT WATER**

Drawing Number: 1567560.0001

Drawing Title: Bretforton Rd, Evesham, WR11 7PE

Design:	Technical Officer:	REV.
Name: M. Gardiner	SC	
Signature:		A
Date: 04/11/25	04/11/25	